

Ashton Woods

1701 Pegasus Drive Forney TX,
75126

Active
Oct 2022

SQUARE FT.
2,861 sq. ft.

PRICE
\$545,000

GARAGE



2

STORIES



2

BEDROOMS



5

BATHS



3 Baths



WELCOME TO The Henderson

Beautiful new Ashton Woods Home only 22 miles to downtown Dallas, minutes to I30, I80, and within the amenity rich, master planned community of Gateway Parks in Forney. This new home community features resort style pool, splash area, outdoor gathering and picnic areas, miles of walking, hiking and biking trails, fitness area, community clubhouse, and greenspaces. This Henderson home plan contains the gorgeous rockwell essential collection, 5 bedrooms, 3 bathrooms, a first-floor guest suite, flex room, walk-in closets, and a charming ACME brick/Waterford limestone exterior with wood window shutters and garage door opener. Inside this 2800+ sq. ft. home, luxury boardwalk vinyl plank upgraded flooring flows throughout the first floor. Entertain guests in the open kitchen-living-dining area complete with upscale finishes like an elongated eat-in bar top island, matte black Moen faucet, an undermount 50/50 sink, Energy Star Whirlpool stainless steel gas appliances, dishwasher, 2x5 picket ceramic backsplash tile, silestone marengo solid surface quartz countertops, pure white 42-inch shaker cabinets, matte black pendant lights, upgraded flooring and a walk-in pantry. Easily use the first-floor flex room as a home office space, if needed! Enjoy your 60' homesite from the backyard covered patio fully landscaped with full sprinkler system and fenced in private back yard! On the second floor, a large game room, three secondary bedrooms, a full secondary bath with ceramic tile flooring and tub surround, ceramic tile utility room, and a spacious primary suite complete the floor. The primary suite offers a spacious ceramic tile shower with glass enclosure, garden tub, double sink vanity with Moen faucets, ceramic tile flooring, lighting package, hardware package and a grand walk-in closet. This luxe new home also has matte black moen plumbing and door hardware, energy efficient lighting, dual pane windows, landscape package, LED disc lighting, ceramic tile flooring in all baths, a covered front porch, a smart home package with a Ring doorbell, 8' front door, full gutters, and so much more!

About Gateway Parks 60s

Now Selling! Introducing the newest Ashton Woods' master-planned community, Gateway Parks, located just 22 miles from downtown Dallas, between US80 and I-20, in Forney, Texas. New homes on 60ft wide single family home sites with fully fenced in yards. Gateway Parks will connect with Gateway Marketplace, an expansive 2,000-acre development with future highlights such as fine dining, shopping and retail, offices, entertainment venues, schools, and more. Discover the beautiful homes within this close-knit community and fun-filled amenities for the entire family. You'll love the resort-style amenity center with its own clubhouse, fitness area and splash pad and another resort-style pool. Throughout the community you'll find a system of scenic walking trails, parks, an outdoor pavilion and picnic areas, event lawn, greenbelts, open spaces, parks, and so much more. Here, at Gateway Parks, you can choose from a variety of home floorplans that fit you and your family's lifestyle. Then, add your own personalized touches through refined Collections. Just choose the Collection that best reflects your style and the extraordinary life you live. It's that simple. With Ashton Woods Collections, your home's design isn't just beautiful – it's simply exceptional. Together, we'll create a home that's a reflection of you and your family's personal sense of style. Whether inspired by the fun-filled amenities or the close-knit community feel, you'll love the possibilities at Gateway Parks.



CALL TO LEARN MORE AND REQUEST A TOUR TODAY

469-502-5176

ASHTONWOODS.COM

SQUARE FT.
2,861 sq. ft.

PRICE
\$545,000

GARAGE
 2

STORIES
 2

BEDROOMS
 5

BATHS
 3

ACTIVE
Oct 2022

First Floor C

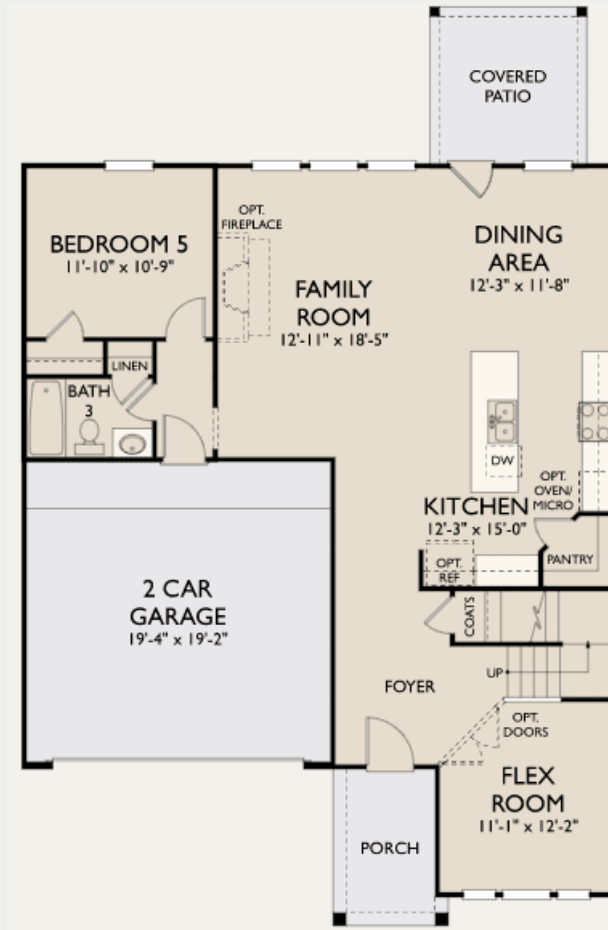

Second Floor C



© 2022 Ashton Woods Homes. Ashton Woods Homes reserves the right to change plans, specifications, dimensions, designs, elevations and pricing without notice in its sole discretion. Stated dimensions and square footage are approximate and are not representative of a home's actual size or net useable square footage which may be less than the estimated square footage. Floorplans and elevations shown may not accurately represent the actual condition of a home as constructed, and may contain options which are not available on all models. Window, floor and ceiling elevations are approximate, subject to change without prior notice or obligation, may not be updated on the website, and may vary by plan elevation and/or community. Special wall and window treatments, upgraded flooring, fireplace surrounds, landscape and other features in and around the model homes are designer suggestions and not included in the sales price. All renderings, color schemes, floor plans, maps and displays are artists' conceptions and are not intended to be an actual depiction of the home or its surroundings. Basement options are available subject to site conditions. Garage or bay sizes may vary from home to home and may not accommodate all vehicles. Home site premiums may apply. While we endeavor to display current and accurate information, we make no representations or warranties regarding the information set forth herein and, without limiting the foregoing, are not responsible for any information being out of date or inaccurate, or for any typographical errors. Please see Sales Representative for additional information, including current floor plans. This is not an offer to sell real estate, or solicitation to buy real estate, in any jurisdiction where prohibited by law or in any jurisdiction where prior registration is required, including New York and New Jersey.